

FLOOR PLANS MUST BE RETURNED AT LEAST 10 DAYS BEFORE RESERVATION DATE

RETURN TO STOW PARKS & RECREATION 3760 Darrow Rd Stow, OH 44224. • PHONE: 330-689-5100 • FAX: 330-689-2895 • PARKS@STOW.OH.US

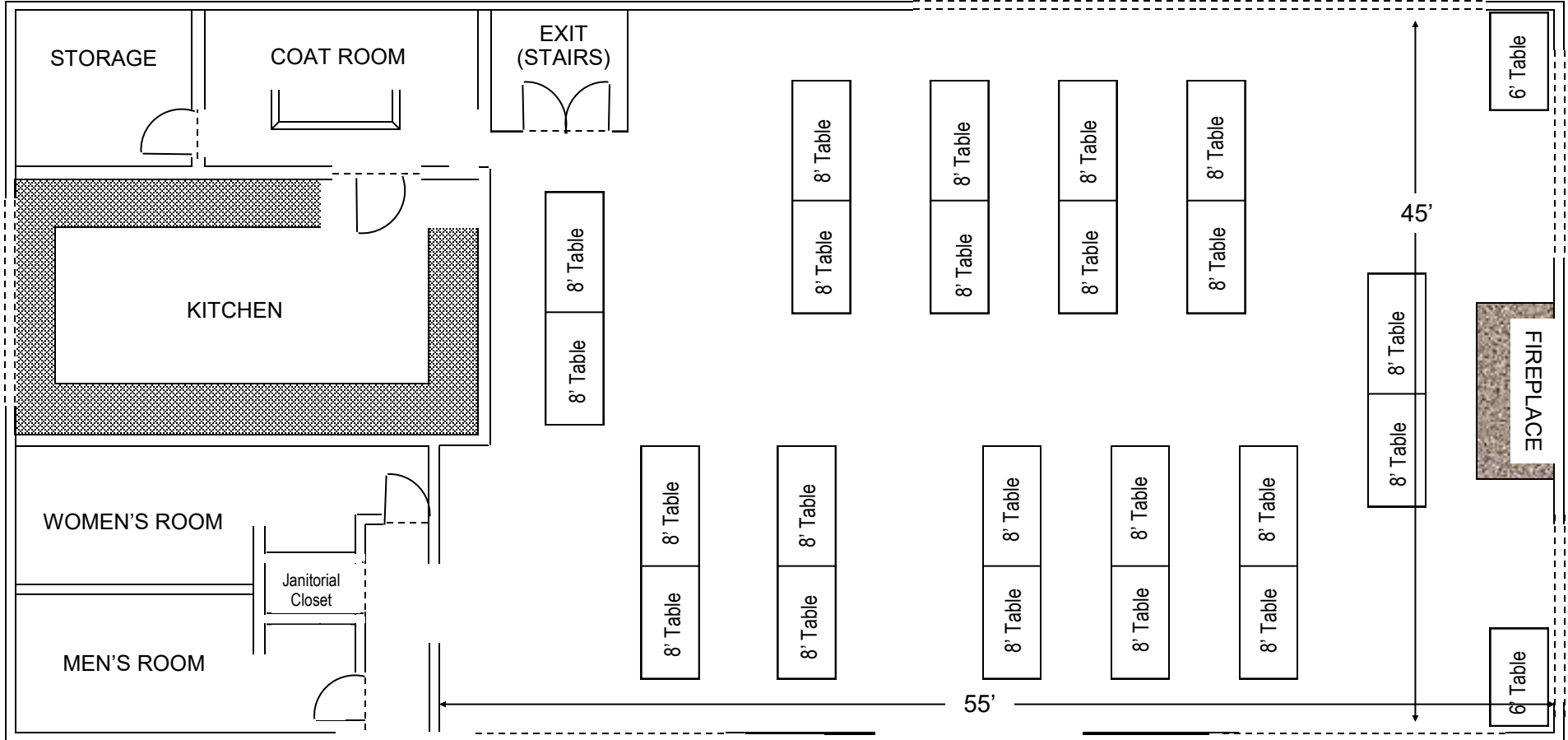

Name of Party _____

Date of Party _____

Number in Party _____

Notes _____

City of Stow Parks & Recreation
THE LEONA FARRIS LODGE (SILVER SPRINGS LODGE)
 FLOOR PLAN - A

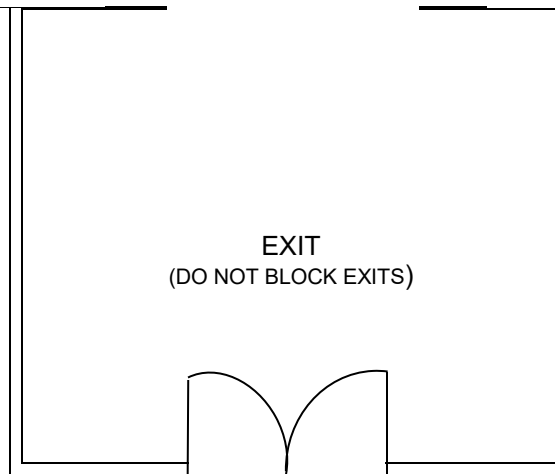

LODGE EQUIPMENT

- 22 - 8 FT. Tables
- 8 - 5 FT. Round Tables
- 4 - 6 FT. Tables
- 160 Folding Chairs
- **Commercial Refrigerator & Freezer / Warming Oven / Microwave**

PLEASE SPECIFY IF YOU NEED FIREWOOD

FLOOR PLANS MUST BE RETURNED AT LEAST 10 DAYS BEFORE RESERVATION DATE

RETURN TO STOW PARKS & RECREATION 3760 Darrow Rd Stow, OH 44224. • PHONE: 330-689-5100 • FAX: 330-689-2895 • PARKS@STOW.OH.US

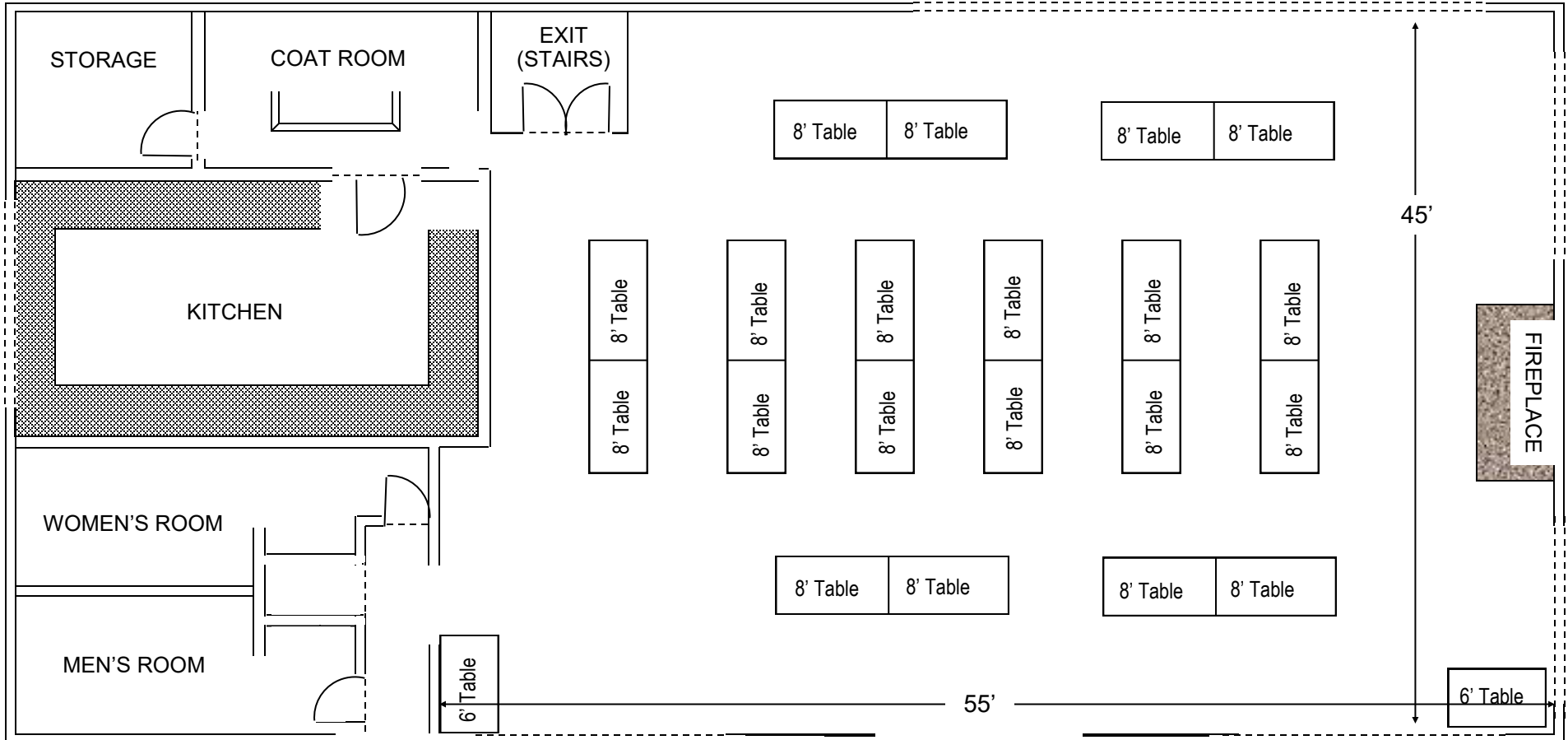

Name of Party _____

Date of Party _____

Number in Party _____

Notes _____

City of Stow Parks & Recreation
THE LEONA FARRIS LODGE (SILVER SPRINGS LODGE)
 FLOOR PLAN - B

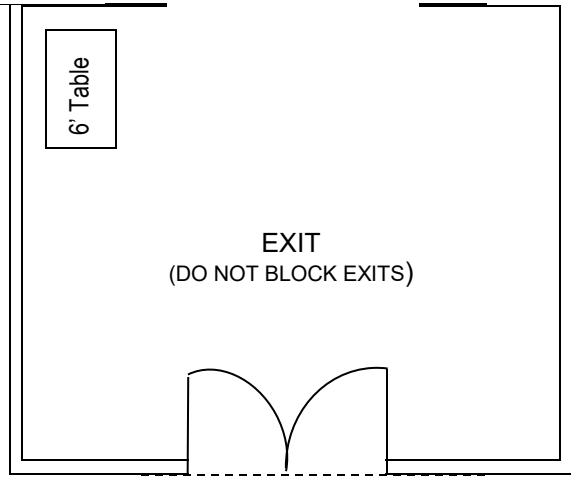

LODGE EQUIPMENT

- 22 - 8 FT. Tables
- 8 - 5 FT. Round Tables
- 4 - 6 FT. Tables
- 160 Folding Chairs
- **Commercial Refrigerator & Freezer / Warming Oven / Microwave**

PLEASE SPECIFY IF YOU NEED FIREWOOD

FLOOR PLANS MUST BE RETURNED AT LEAST 10 DAYS BEFORE RESERVATION DATE

RETURN TO STOW PARKS & RECREATION 3760 Darrow Rd Stow, OH 44224. • PHONE: 330-689-5100 • FAX: 330-689-2895 • PARKS@STOW.OH.US

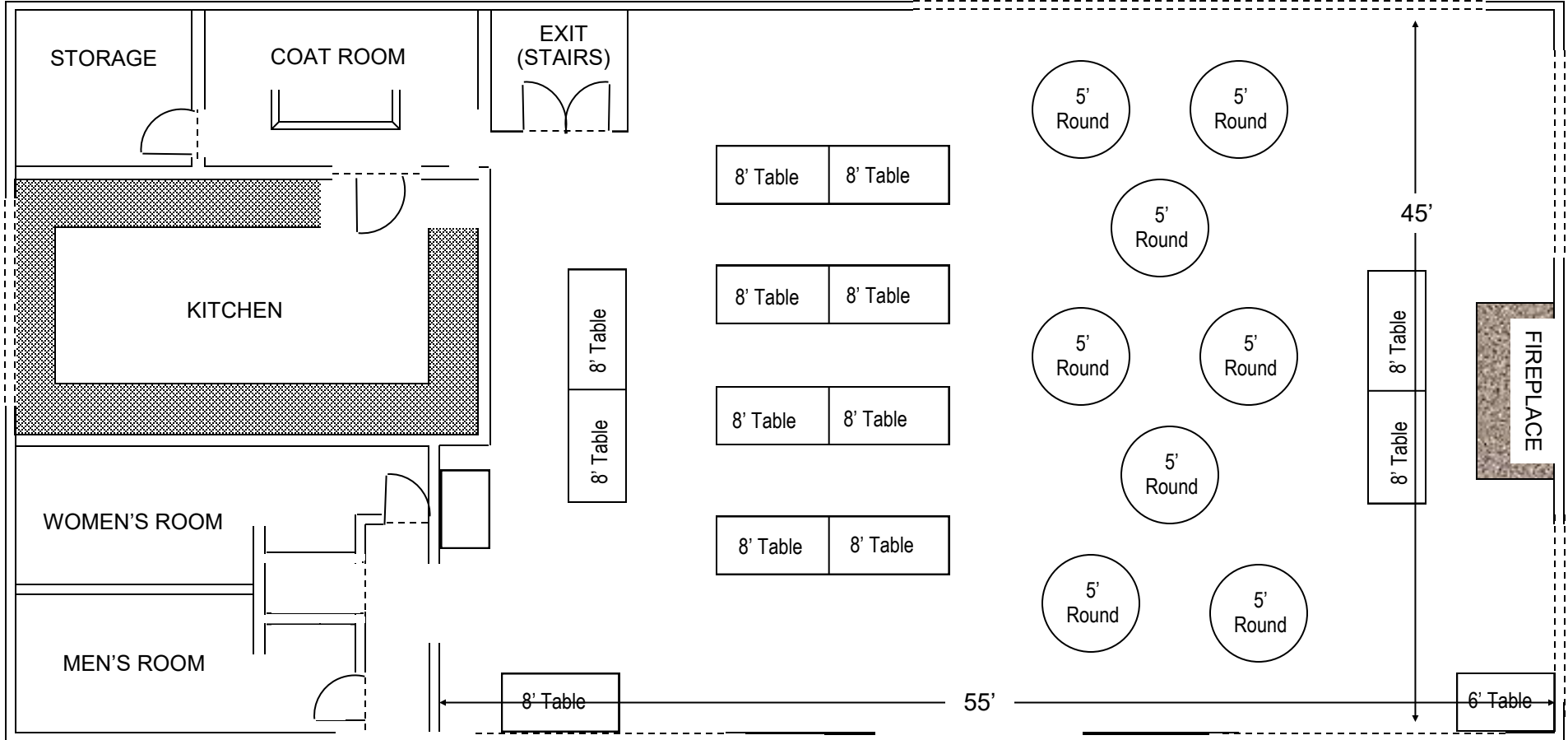

Name of Party _____
 Date of Party _____
 Number in Party _____
 Notes _____

City of Stow Parks & Recreation
THE LEONA FARRIS LODGE (SILVER SPRINGS LODGE)
 FLOOR PLAN - C

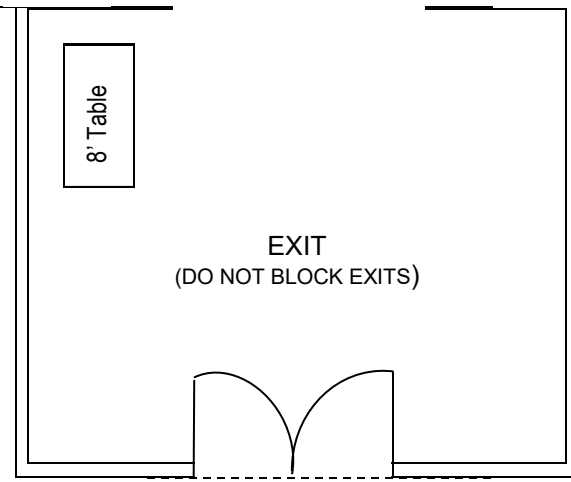

- LODGE EQUIPMENT**
- 22 - 8 FT. Tables
 - 8 - 5 FT. Round Tables
 - 4 - 6 FT. Tables
 - 160 Folding Chairs
 - **Commercial Refrigerator & Freezer / Warming Oven / Microwave**
- PLEASE SPECIFY IF YOU NEED FIREWOOD

FLOOR PLANS MUST BE RETURNED AT LEAST 10 DAYS BEFORE RESERVATION DATE

RETURN TO STOW PARKS & RECREATION 3760 Darrow Rd Stow, OH 44224. • PHONE: 330-689-5100 • FAX: 330-689-2895 • PARKS@STOW.OH.US

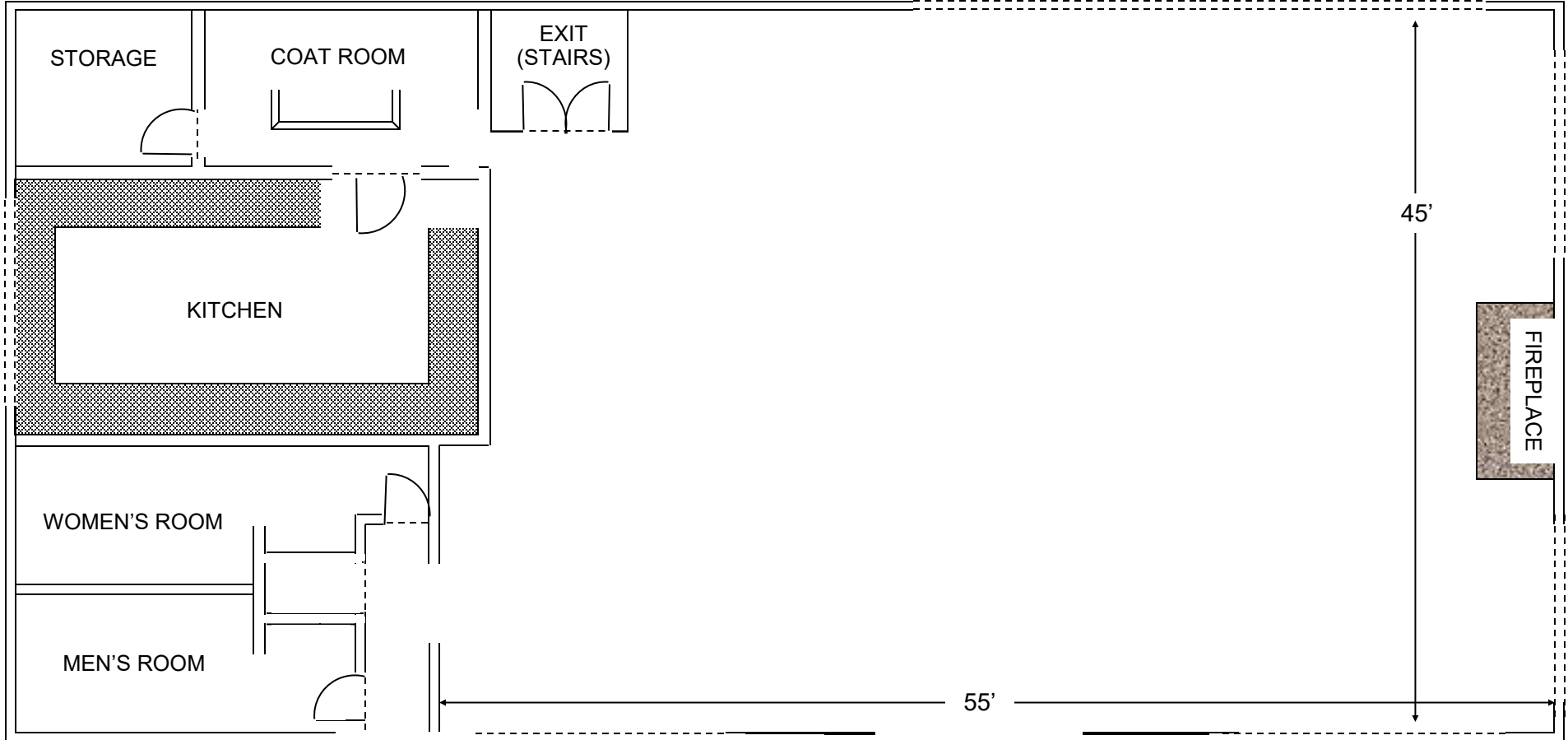

Name of Party _____

Date of Party _____

Number in Party _____

Notes _____

City of Stow Parks & Recreation
THE LEONA FARRIS LODGE (SILVER SPRINGS LODGE)
 FLOOR PLAN - D

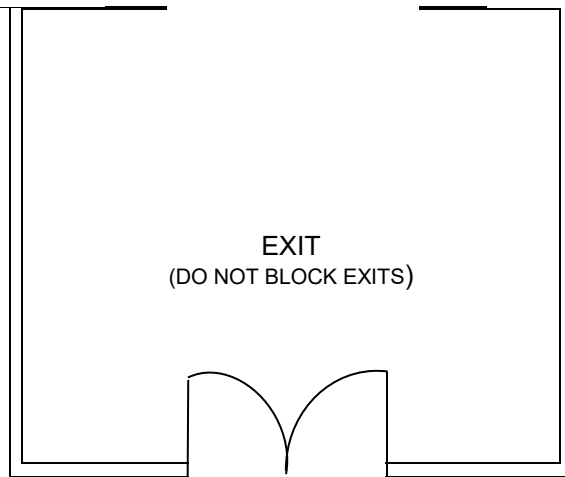

LODGE EQUIPMENT

- 22 - 8 FT. Tables
- 8 - 5 FT. Round Tables
- 4 - 6 FT. Tables
- 160 Folding Chairs
- **Commercial Refrigerator & Freezer / Warming Oven / Microwave**

PLEASE SPECIFY IF YOU NEED FIREWOOD